

*hilly Land*

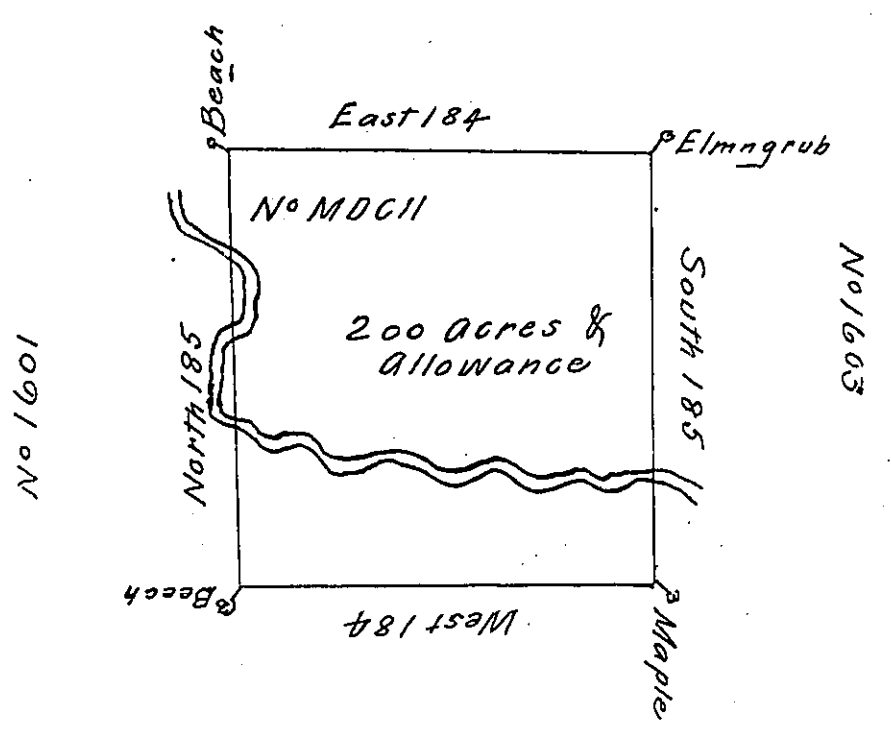

00910N

*In pursuance of an Act of General Assembly of the State of Pennsylvania, passed the 24<sup>th</sup> day of February, 1785, entitled "An Act for directing the mode of distributing the Donation Lands promised the Troops of this Commonwealth"; and by order of the Surveyor General with the approbation of the Honourable the Supreme Executive Council, I have Surveyed on the 19<sup>th</sup> day of October 1785. the above described Tract of two hundred acres of land, and allowance of Six per Cent, for roads, &c. No. 1602 Situate in District No. 8. on the West Side of the Allegany River in the County of Westmoreland.*

*To John Lukens, Esq. } Alexander M<sup>d</sup> Dowell D.S.  
Surveyor General }*

*IN TESTIMONY that the above is a copy of the original remaining on file in the Department of Internal Affairs of Pennsylvania, made conformably to an Act of Assembly approved the 16th day of February, 1833, I have hereunto set my Hand and caused the Seal of said Department to be affixed at Harrisburg, this Twenty fifth day of August 1908*

*Henry Howell*  
Secretary of Internal Affairs.